

# OFFICE/WAREHOUSE SPACE

3100 MERCER UNIVERSITY DRIVE  
MACON, GA 31204  
BIBB COUNTY

15,500 SF TOTAL  
3 SPACES AVAILABLE

## LEASE RATE:

3120 – \$5.50/SF

3146 - \$6/SF

3158 - \$7/SF



KEVIN HARKINS C: 478.338.0623  
KHARKINS@THESUMMITGROUPMACON.COM  
4124 ARKWRIGHT ROAD, SUITE 1, MACON, GA 31210  
O: 478.750.7507  
WWW.THESUMMITGROUPMACON.COM



## PROPERTY INFORMATION

- 3 spaces available
  - 3120 – 7,500 SF | **Lease Rate: \$5.50/sf**
    - 20 ft center ceiling height
    - Three 8ft dock high roll up doors
  - 3146 – 5,000 SF | **Lease Rate: \$6.00/sf**
    - 18 ft center ceiling height
    - One 10 ft dock high roll up door
    - One 10 ft drive in roll up door
  - 3158 – 3,000 SF | **Lease Rate: \$7.00/sf**
    - 20 ft center ceiling height
    - Three 8 ft dock high roll up doors
- Located at the intersection of Mercer University Drive & Henderson Drive, inside the Westside Business Center



3100 MERCER UNIVERSITY DRIVE  
MACON, GA 31204



## PROPERTY INFORMATION

- Dock high and ground level truck access
- Some spaces have retail/showroom space
- Ample parking
- Traffic Count: 2021 GDOT data estimate  
Mercer University Drive - 24,400  
VPD



3100 MERCER UNIVERSITY DRIVE  
MACON, GA 31204



# FLOOR PLANS

Space 3120  
NOT drawn to scale

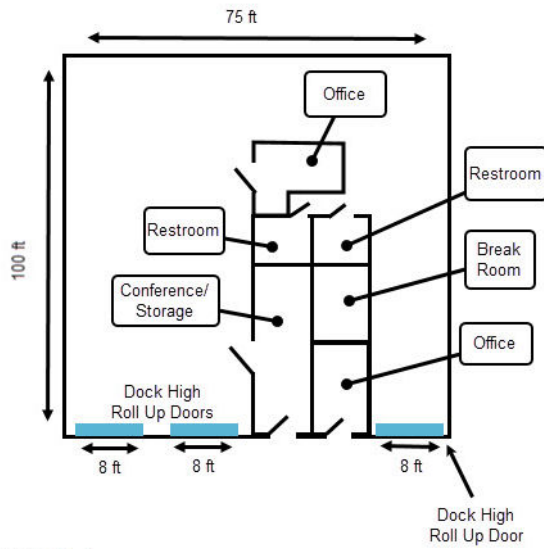

7,500 SF Total

Space 3146  
NOT drawn to scale

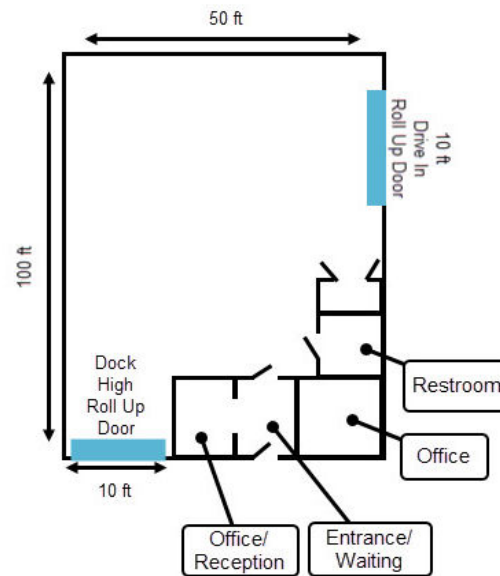

5,000 SF Total

Space 3158  
NOT drawn to scale

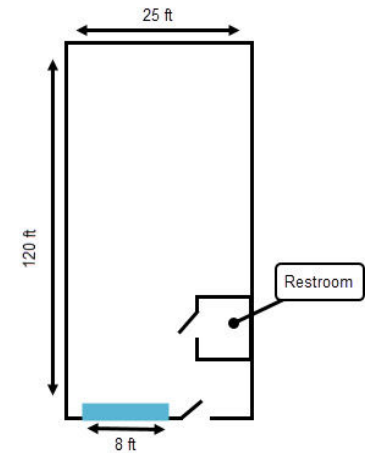

3,000 SF Total

3100 MERCER UNIVERSITY DRIVE  
MACON, GA 31204



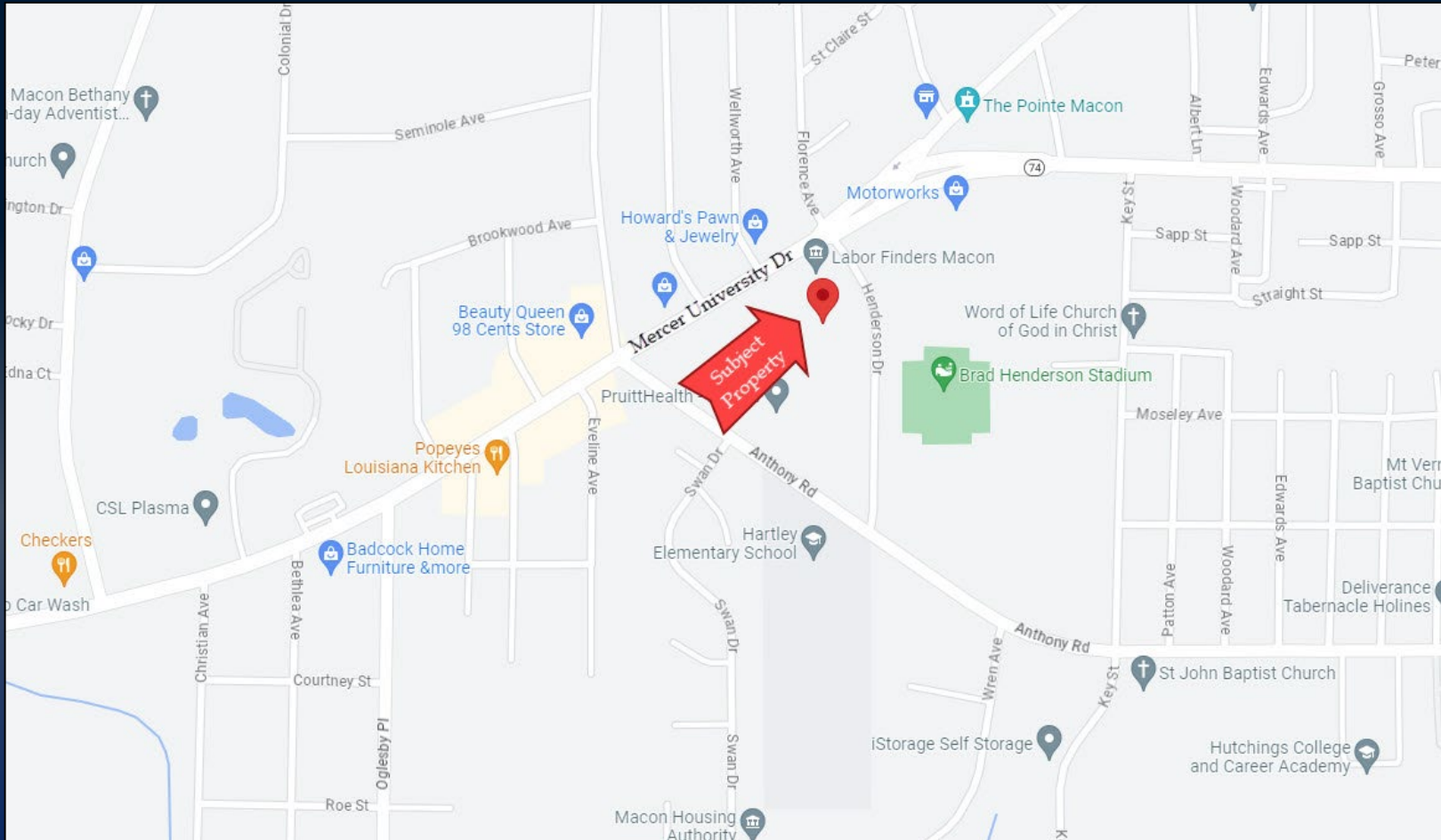

## 3100 MERCER UNIVERSITY DRIVE MACON, GA 31204



*The information contained herein has been compiled from various sources, both private and public. It is accurate and complete only to the extent to which The Summit Group has been able to ascertain from third party sources. As such, no warranty or guarantee is given or implied with regard to the accuracy or completeness of any information contained herein. Any interested party shall be required to conduct its own due diligence and investigations to verify, review, audit, or otherwise insure the information contained herein.*